

# Concrete pump

# BSA 1005 D

Output up to 52 m<sup>3</sup>/h  
 Delivery pressure up to 70 bar

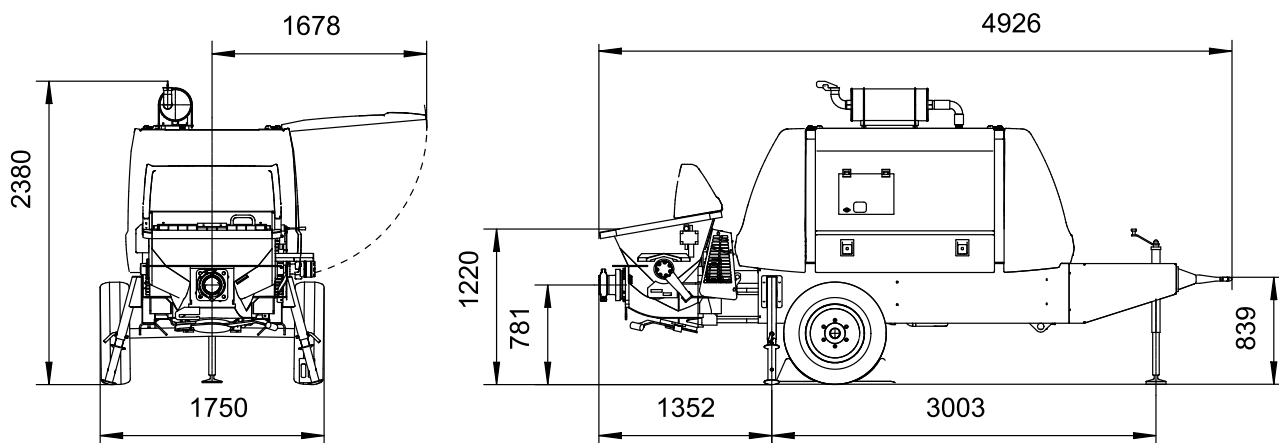

Note: Standard version. Dimensions and weights depend on equipment.

### Performance diagram

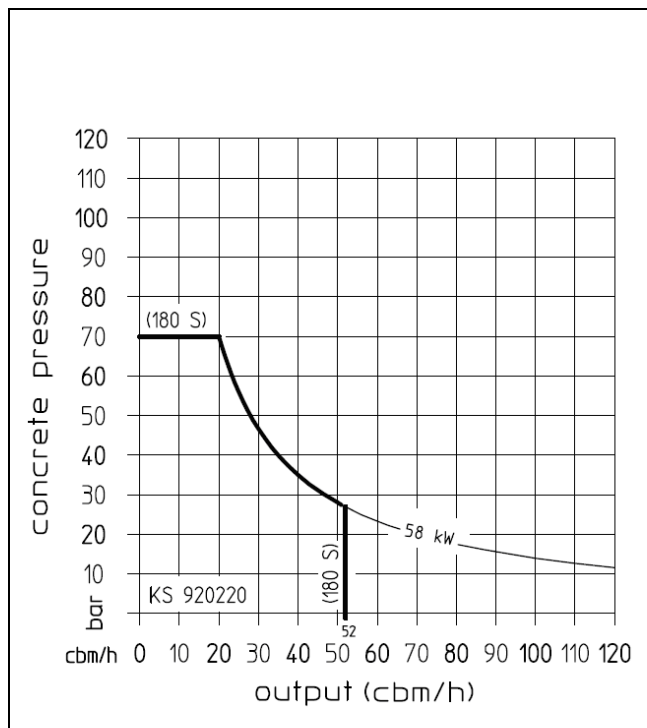

### Technical data for concrete pump

Model BSA 1005 D		102310.000
Material number		102310.000
Output	m <sup>3</sup> /h	52
Delivery pressure	bar	70
Delivery cylinder	Ø mm	180
Delivery cyl. stroke	mm	1000
Strokes / minute		35
Engine power	kW	58
Hopper		RS 487K
Capacity	l	ca. 350
Filling height	m	1,2
Transfer tube		S 1812
line connection	mm	SK 125
Pressure connection coupling	"	5,5
Control system		OPS
Fuel capacity	l	120
Weight	kg	3000

All data maximum theoretical

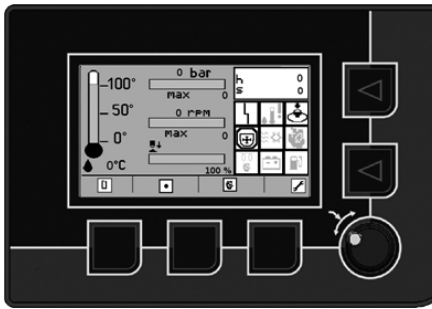

EGD - Ergonic Graphic Display

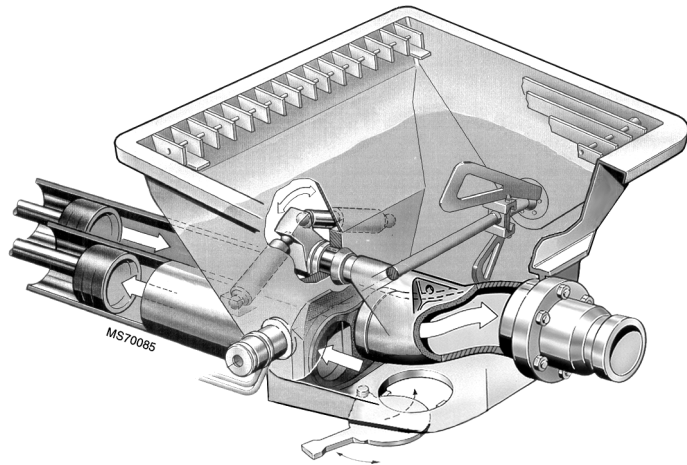

Hopper with transfer tube

### Delivery scope

- Drive diesel, Deutz 4-cyl. turbo engine, 58 kW, electronic engine management
- Agitator safety switch off
- Cable remote control 10 m
- CE-Version:
  - Side flaps
  - Cover over switch cylinder
- Central lubrication hopper manually
- Cleaning accessories
- Concrete hopper with agitator
- Coupling ring (DIN)
- Grill 70 mm
- Operating manuals cert. and spare part lists 2x
- Splash guard
- Square outriggers 4x mech. 15°-slanging
- Support leg on tow bar
- Tool set incl. standard equipment
- Trailer F8, travelling on site
- Painting:
  - Cover MB 1227 chrome yellow / black
  - Pump, frame and trailer RAL 7035 light-grey
  - Roof and splash guard RAL 7021 black-grey

### Ergonic equipment

- Concrete output adjust, electrically (EPS)
- Concrete pressure adjust (EPS)
- Electronic error management
- Operating data for pump and engine shown in Ergonic Graphic Display (EGD)
- Output delivery meter
- Speed drawdown automatically on pump stop (EPS)

### Optional extras

On request

**Please see quotation for detailed delivery scope.**